

SITE PLAN SHOWING THE AREA OF PROPOSED RESIDENTIAL APARTMENT BUILDING OF " **K.B. ENTERPRISE**" PARTNERS- **1. KALYAN KUMAR DHARA, S/O- LT. SHYAMCHARAN DHARA AT HANSPUKUR, P.O. + P.S.- MIDNAPORE, DIST- PASCHIM MEDINIPUR, 2. BIJOY KUMAR DAS, S/O- LT. PURNA CHANDRA DAS AT CHIRIMARSAI, P.O. + P.S.- MIDNAPORE, DIST- PASCHIM MEDINIPUR ON MOUZA- CANTONMENT BARPATHAR, J.L. NO. - 168, R.S. & L.R. PLOT NO- 544/867(P), 544/869(P); P.S.- MIDNAPORE, DIST-PASCHIM MEDINIPUR, UNDER MIDNAPORE MUNICIPALITY AREA.**

DEVELOPER'S- "GRAND SPACE INFRA" REPRESENTED BY-  
 1. SRI ARDHENDU SARKAR, S/O- SRI AMALENDU SARKAR,  
 2. SRI SWAPAN KUMAR JANA, S/O- LT. TARAK BRAHMA JANA,  
 3. SRI SUDIPTA BOSE, S/O- TULSI CHARAN BOSE,  
 4. SRI SUBRATA SARKAR, S/O- BHUJANGA BHUSAN SARKAR,  
 5. SRI BIJOY KUMAR DAS, S/O- LT. PURNA CHANDRA DAS  
 AT ALIGUNJ, LIBRARY ROAD, P.O.- MIDNAPORE, P.S.- KOTWALI,  
 DIST- PASCHIM MEDINIPUR.

[ALL DIMENSIONS ARE IN MTR. & SCALE-1:450]

AREA OF TOTAL LAND = 930.77 SQ. M. - 

PRO. AREA OF CONSTRUCTION MARKED AS- 

MAX. PERMISSIBLE CONSTR. AREA= 465.39 SQ. M= 50.00 % OF TOTAL PLOT AREA  
 PRO. HEIGHT OF CONSTRUCTION - 20.0 MTR.

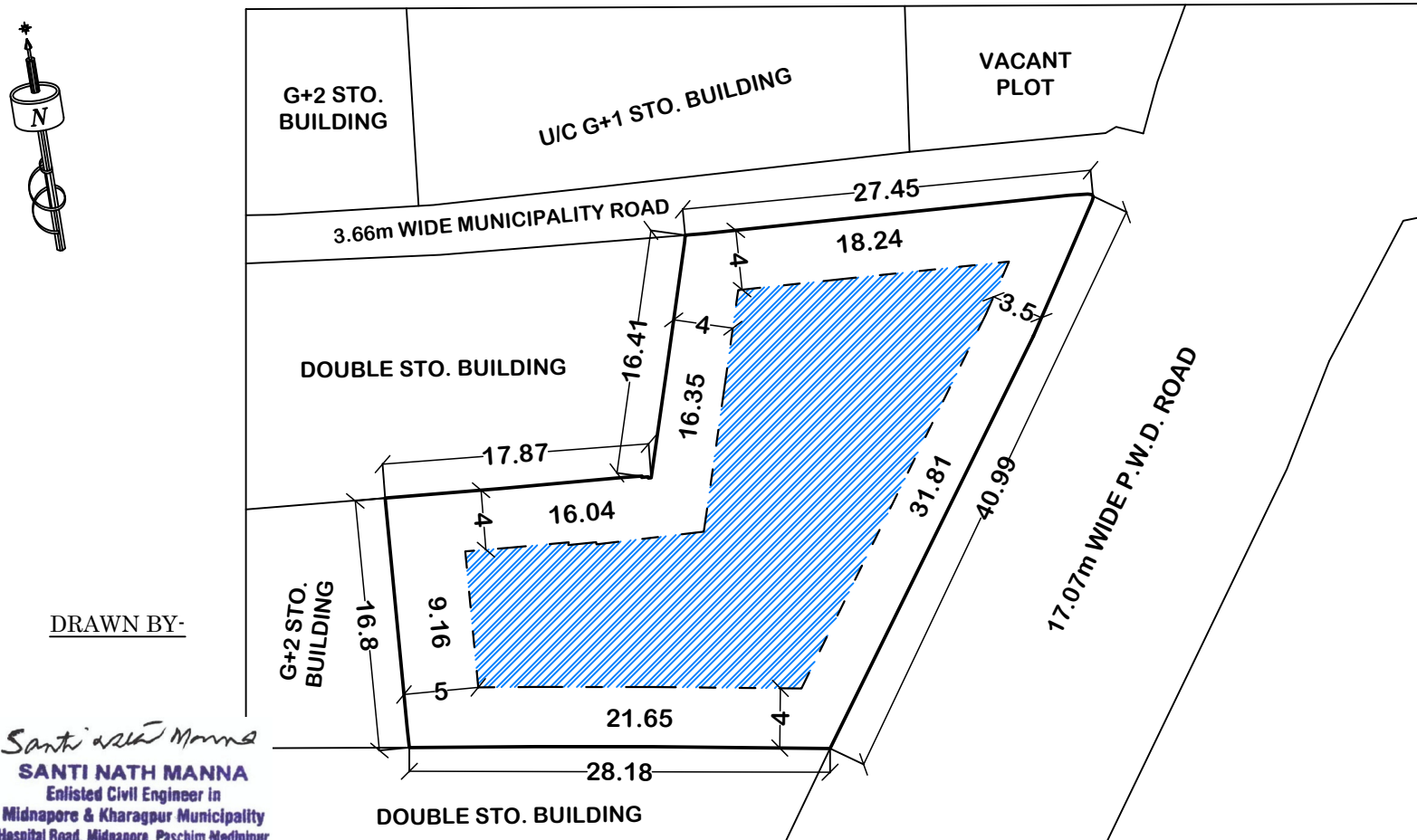

①

②

SIGNATURE OF THE  
LAND OWNER'S

DRAWN BY-

*Santi Nath Manna*  
**SANTI NATH MANNA**  
 Enlisted Civil Engineer in  
 Midnapore & Kharagpur Municipality  
 Hospital Road, Midnapore, Paschim Medinipur

SIGNATURE OF THE  
DEVELOPER'S